

Compact digital positioner with IO-Link for mounting on pneumatic valves

- IO-Link interface (V1.1.3)
- Direct „top-mounted“ attachment to the valve drive. This means that no parts of the stroke return are accessible from the outside.
- Large stroke range 3 - 28 mm, optionally up to 50 mm.
- Reverse hysteresis of up to 0.2% possible, standard 0.4%
- Configuration adjustment through self-adaption
- Configuration and diagnostic functions via IO-Link or via “Device-Config” software
- Low vibration sensitivity
- Protection class IP 65
- Also for rotary actuators
- Low air consumption in the regulated state



Technical data

Nominal stroke	3 - 28 mm (optional up to 50 mm)
Ambient temperature	-10 °C up to + 75 °C
Control Signal	IO-Link
IO-Link Interface	V 1.1.3
IO-Link Porttype	Class A
Current	max. 500 mA
Supply voltage	24 V DC (18-30 V)
Adjustment of stroke and zero point	self-adjustment
configuration	IO-Link or Software „DeviceConfig“
auxiliary energy, pneumatic	max. 6 bar
Air flow capacity	40 NI/min
Consumption of auxiliary energy in the controlled state	< 0,06 NI/min
Leakage	< 0,01 NI/min
Air quality according ISO 8573-1:	
max. particle size and density:	Class 5
oil content	Class 4
pressure dew point	Class 3
	min. 20 K (36 °F) under ambient temperature
Actuation gas	compressed air or non flammable gases (nitrogen, CO ₂ ,...)
Mounting to control valve	standardized mounting kits (also with optical position indicator)
Pressure supply port	G 1/8"
Protection class acc. DIN 40050	IP 65

* at 5 bar pilot pressure

Functional description

With its integrated IO-Link interface, the 8049-IO1 positioner offers a solution for controlling, parameterizing and diagnosing via its higher-level process control system. Based on the proven 8049-4 positioner (version 6), IO-Link is not only used to specify the setpoint, but also to set the positioners parameters, e.g. positioner hysteresis, tight shut-off function etc., and read out diagnostic or maintenance data, e.g. number of switching cycles, operating hours, valve travel, etc. The maximum data rate is 230.4 kBit/s, the cycle time is exceptionally fast at 1.1 ms. In addition, the configuration of the 8049-IO1 is still possible by means of the PC software „DeviceConfig“.

Materials

	standard version	version „ground plate in stainless steel“	version „completely stainless steel“
positioner housing	Vestamid (electroconductive)	Vestamid (electroconductive)	stainless steel
ground plate	Aluminium, KTL-coated	stainless steel	stainless steel

Ordering number system

												quote only if required											
8049/		-								-													
Basic design																							
digital positioner 8049-IO-Link		IO1																					
For actuator																							
single acting			1																				
Air delivery																							
standard					S																		
high					H																		
Body																							
aluminium / plastic						0																	
stainless steel ground plate						1																	
Electro-pneumatic connection																							
plug connection M12x1, 5-pin						2																	
Pneumatic connection																							
G 1/8"						0																	
NPT 1/8"						1																	
Position measuring																							
linear potentiometer without sensing pin											0												
linear potentiometer with standard sensing pin (L=3,92")											1												
linear potentiometer with curtated sensing pin (L=3,72")											G												
rotary potentiometer for semi-rotary drive											2												
EMV-galvanic separating module for exterior path sensor											3												
Optical indicator																							
without indicator											0												
indicator disc for sensing pin in PA											1												
indicator disc for sensing pin in metal											2												
rotation angle indicator											3												
Auxiliary module																							
without auxiliary module												0											
Accessories																							
without accessories																						0	
gauge bloc single acting, scaling in bar and PSI																						1	
optical position indicator for rotating actuators																						2	
Optical position indicator for rotating actuators																							
special design (quote only if required)																						S	
positioner montage (only for the manufacturer)																						M	
Settings																							
standard																						-	
settings on customer request																						1	
Special design																							
without																							-
separated version incl. exterior path sensor for lift drive																							1

Dimensions

For linear actuators

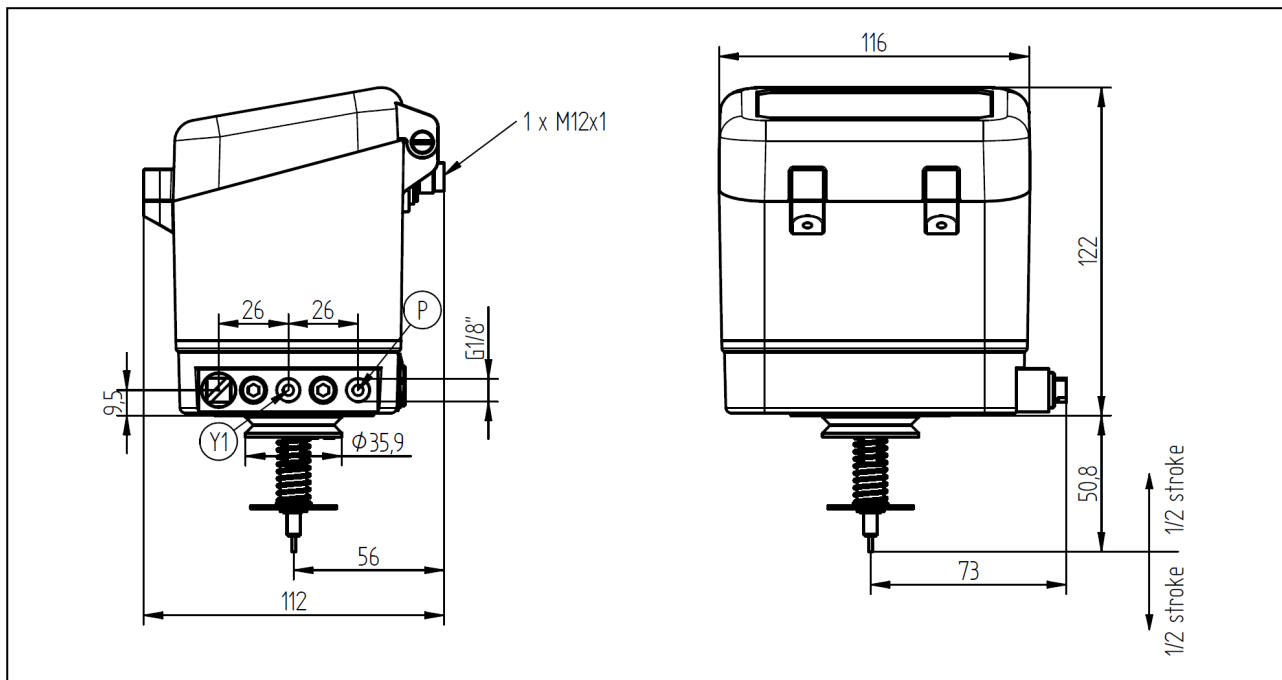

For quarter turn actuators

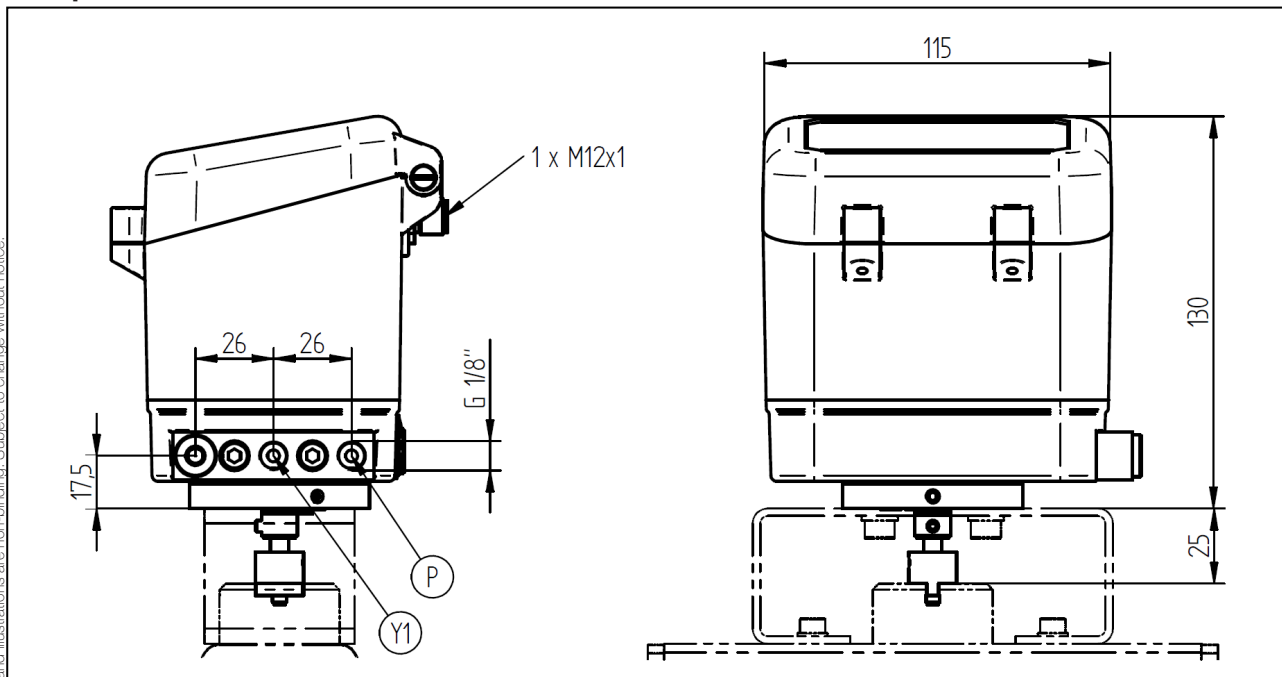

Information and illustrations are non-binding. Subject to change without notice.